



PRODUCT BULLETIN #517

M14 12,000 LBS. TORFLEX® FOR MARINE APPLICATIONS

September 5, 2025

Dexter is pleased to announce the addition of the M14 12,000 lbs. Torflex axle with Kodiak® disc brakes designed for the boat trailer market. This system features corrosion-resistant beams and calipers, with straight or center V-bend options available. Pair the M14 with Dexter's recommended brake actuators for optimal stopping power.

This system will be available to order from all Dexter manufacturing locations as well as Dexter's extensive distribution network. Please refer to the next page for M14 specifications and options.

M14 AXLE:



HIGH PROFILE BRACKET:

The right-hand side of the axle is shown.

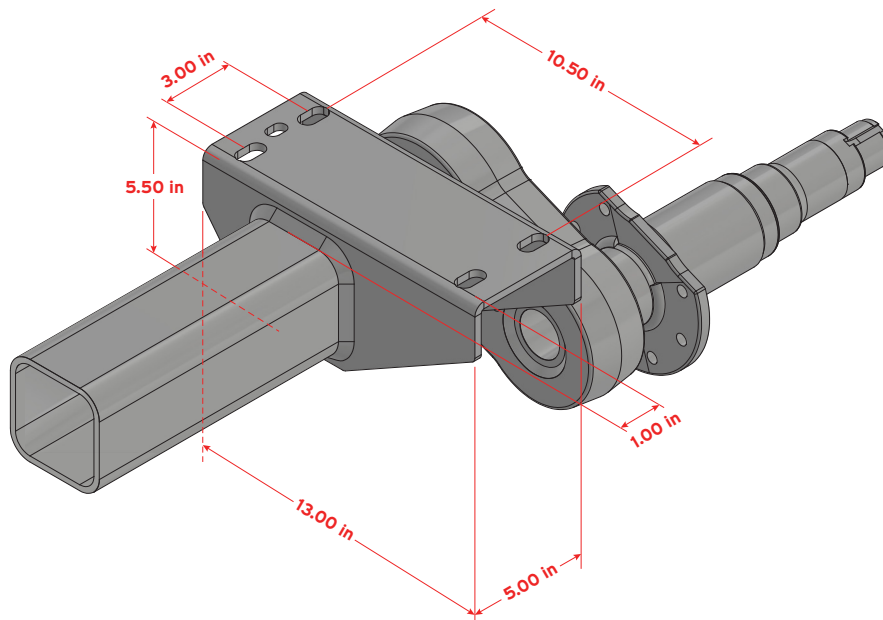

M14 AXLE SPECIFICATIONS:

ATTRIBUTE	DESCRIPTION
TUBE SIZE	4.25" OD SQUARE
SPINDLE TYPE	#14 WITH BRAKE FLANGE FOR KODIAK DISC BRAKES
LUBRICATION	GREASE
CAP - FORTRESS®	K71-182-00
HUB	008-422-04 HUB CUPPED & STUDED 5/8" STUD, 8 ON 6.50" BOLT CIRCLE, BLACK E-COAT
HUB/ROTOR SPACER	033-RTR-120-DW-SPC
ROTOR - GAL-DEX®	070-RTR-13-10-D
BEARINGS/RACES	<ul style="list-style-type: none">• 031-020-02 OUTER CONE (3984)• 031-021-02 INNER CONE (28682)
KODIAK DISC BRAKES <i>AXLE NOT OFFERED WITH OTHER DISC BRAKES, DRUM BRAKES, BARE BEAM, OR IDLER CONFIGURATIONS.</i>	GAL-DEX® COATED CALIPERS <ul style="list-style-type: none">• K71-DBC-338-HD-D-L (LH)• K71-DBC-338-HD-D-R (RH)
ACTUATOR OPTIONS	<ul style="list-style-type: none">• DEXTER BRAKERITE® E/H• DEXTER DX SERIES E/H• DEXTER DX20 SURGE ACTUATOR (LIMITED TO 20,000 LBS. MAX. GVWR)• DEXTER DX20EX SURGE ACTUATOR (LIMITED TO 20,000 LBS. MAX. GVWR)
OVERHANG OPTIONS	<ul style="list-style-type: none">• MINIMUM OVERHANG - 25.50"• MAXIMUM OVERHANG - 34.25"
HUB FACE	<ul style="list-style-type: none">• MAXIMUM HUBFACE - 116"• MINIMUM HUBFACE W/ V-BEND OPTION - 92.50"
WHEELS	ONLY SINGLE WHEELS CAN BE USED DUE TO 13" ROTOR.
START ANGLES	22.5° UP, 10° UP, 0°, 10° DOWN, 22.5° DOWN, 32° DOWN, 45° DOWN
BRACKET OPTIONS	5" WIDE 1" HI-PROFILE UNIVERSAL BRACKET
BEAM OPTIONS	<ul style="list-style-type: none">• CENTER V-BEND - 2.50"• STRAIGHT
AXLE CONFIGURATION	SINGLE OR TANDEM AXLE APPLICATIONS
FOR USE WITH MARINE/BOAT TRAILER APPLICATIONS ONLY	

Please contact your Dexter account manager for additional information and further assistance.



Jay Klinkerman
Product Manager