

Date: February 2, 2023

Subject: New Light-Duty Spindle Nut Attachment System

Dexter is excited to announce a new, robust hub or hub-drum retention system for Sprung and Torflex® axles rated at 2,000 – 8,000 lbs. to maximize bearing life through more precise bearing adjustment.

The new system uses the existing D-Flat spindle design with an additional cotter pin hole, castellated spindle nut retainer, and a cotter pin (see below). The new castellated spindle nut retainer provides customers with more precise bearing adjustment ensuring your bearings will go the extra mile.

The new D-Flat spindle with cotter pin system is a running change starting with #8 and #9 Torflex axles but will eventually include all Sprung and Torflex axles up to 8,000 lbs. The attaching hardware will be added to all existing service kits, providing both sets of service parts for D-Flat spindles.

EXISTING D-FLAT SPINDLE WITH CAGE SYSTEM:

Axles produced with existing D-Flat spindles with cage system are **INCOMPATIBLE** with the new spindle nut with cotter pin system.

Cage system replacement part kits will be required for service parts for spindles without a cotter pin.



NEW D-FLAT SPINDLE WITH COTTER PIN SYSTEM:

Both versions of the D-Flat spindle service parts can be used on D-Flat spindles with cotter pins systems.

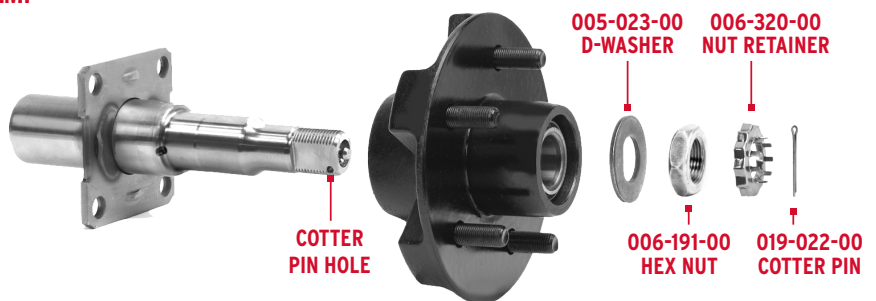

Please contact your Dexter account manager for additional information and further assistance.

Matt Brady
Product Manager